

AS70-K-163 - SPEEDLINE System Data Sheet - Version V1 (24-10-23)

SPEEDLINE 70mm Acoustic 'C' Stud Partition
@600mm Ctrs, with Knauf 15mm Impact Panel
each side

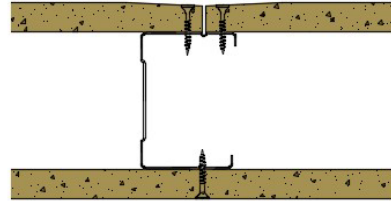

System Performance Breakdown

Fire Resistance:

BS476 Part 22:1987:

Test Ref & Date or Applied Ref & Report:

Max Height:

Thickness:

Duty Grade: BS 5234: Part 2:1992:

Sound Insulation:

60/60 Minutes (Integrity/Insulation).

BRE 285458 - BRE Report P102396-1011B

Refer to Speedline Specification Clause

102 mm. (At Base Track, Excluding Finishes)

Severe - Annexes A-F

40 R_wdB, Date Tested or Assessed Against - AS43-K-154

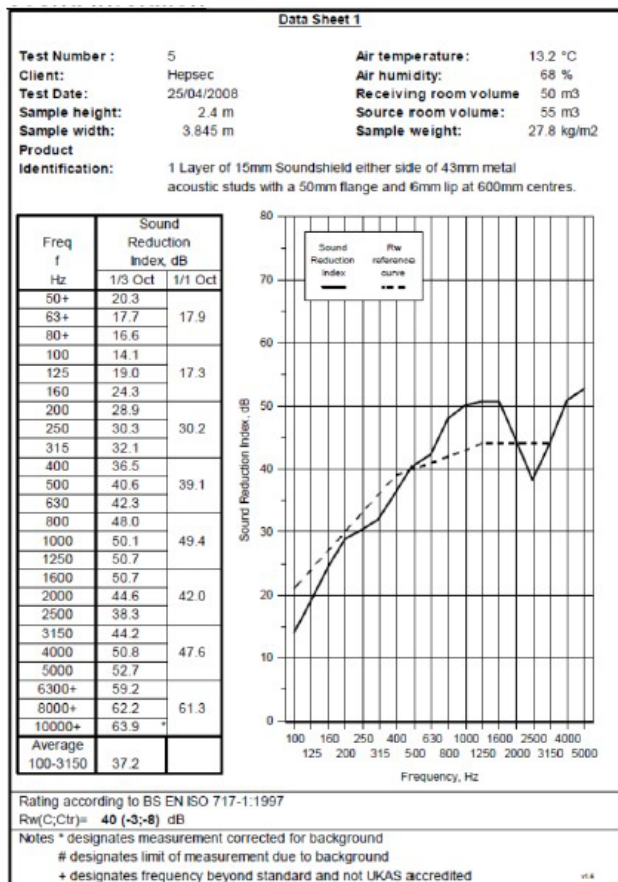

TESTED AT ONE OF THE UKAS
ACCREDITED LABORATORIES
BELOW

B.T.C (H-Ref on Graph)	
B.R.E	
AIRO	
S.R.L	

SPEEDLINE Drywall Systems, Adsetts House, 16 Europa View, Sheffield Business Park, Sheffield, S9 1XH.

Tel: 0114 231 8030.

Email: enquiries@speedlinedrywall.co.uk

(As per the requirements set out in ISO/IEC 17025:2017 regarding test data the results stated have been carried out by voestalpine Metsec plc as part of the contract to supply Speedline Metal Sections to SIG Plc)